

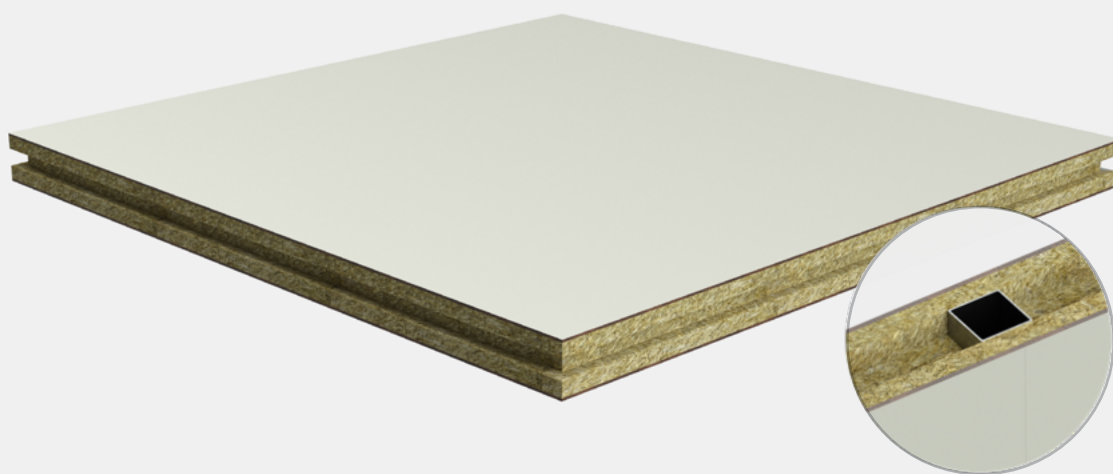

Panel-Est Roc

Mineral wool core walls for white rooms



- The phenolic resin boards of the outer faces of the Panel-Est Roc panel are compact, non-porous and highly resistant to impact and the development of micro-organisms.
- The mineral wool core panel provides high thermal and acoustic properties.



invespanel

Panel-Est Roc



Description and applications

- Sandwich panel with mineral wool core and 3 mm thick phenolic resin exterior faces.
- The panel is specially designed for use in white rooms, partition wall systems and door infills.
- Panel-Est Roc is characterised by its wear resistance and structural stability. Thanks to the design of its components, it is a solution with high resistance to moisture and impact, making it suitable for white rooms, hospitals, laboratories and GMP rooms.



Technical features

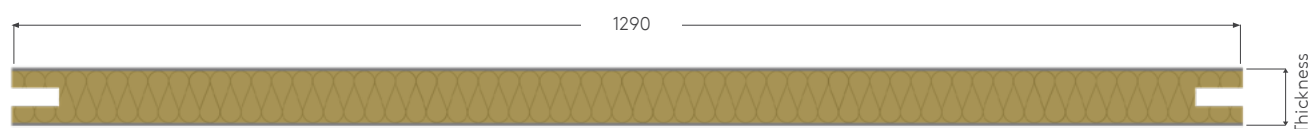

| | | | | | |
|--|-------------------------|---|-------|-------|-------|
| Standard dimensions (width x length) ⁽¹⁾ | | 1290 x 3040 mm / 940 x 2140 mm | | | |
| Insulating core | | Mineral wool | | | |
| Core density | | HD (150 kg/m ³ (+10, -0 kg/m ³)) | | | |
| Panel thickness (mm) | | 30 | 40 | 50 | 60 |
| Dead weight ⁽²⁾ | kg/ml | 15.09 | 17.03 | 18.96 | 20.90 |
| | kg/m² | 11.70 | 13.20 | 14.70 | 16.20 |

(1) Non-standard measurements available upon request.

(2) Considering 3 mm / 3 mm phenolic resin faces (int/ext).

Panel-Est Roc



Components

Insulating core

- HD mineral wool with a density of 150 kg/m³ (+10, -0 kg/m³). Possibility of customised core milling.

Outer faces

- 3 mm thick thermosetting phenolic resin sheets (HPL). For other thicknesses, please consult availability.

Rebated joint

- Rebated joint that allows wall or ceiling support profiles to be housed inside.

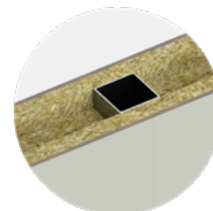

Finishes

Finishing options

- Finish of the outer faces: Smooth finish.

Coatings

- The phenolic resin faces are coated with treatments that improve the reaction to fire and moisture to humidity.

Colors

- The standard colours are Baikar White and Alpine White. For other colours, please check availability.

Perforation option

- Possibility of customised mechanised on the panel.

Certifications and applicable regulations

Implementing regulations raw material

- EN 438-4:2016 manufacturing standard for high-pressure decorative laminates (HPL).
- EN 13162:2012+A1:2015, thermal insulation products for building applications, mineral wool manufacturing standard. Manufactured mineral wool products.

Reaction to fire classification

- The Panel-Est Roc, 60 mm thick and white, has the reaction to fire classification B-s1, d0 according to EN 13501-1:2018 (Euroclasses).



Download the latest version by scanning the QR code or by clicking [here](#)

Kingspan | Invespanel is a trademark of Teczone Española S.A.U., and reserves the right to modify the contents of this document without any prior warning. Every effort has been made to ensure that the content of this publication is accurate, but Teczone Española S.A.U. and its affiliated companies are not responsible for errors or information that may be misleading. Suggestions regarding the final use or application of the products or work methods are merely informative and Teczone Española S.A.U. and its affiliates do not accept any responsibility in this regard.

Kingspan | Invespanel

Pol. Buicio, Sector 6 Nave 4
E - 26360 Fuenmayor (La Rioja)
T: +34 941 450 923
E: info@invespanel.com
www.invespanel.com

